

VERDE DESIGN
 LANDSCAPE ARCHITECTURE
 CIVIL ENGINEERING
 SPORT PLANNING & DESIGN
 2455 The Alameda
 Santa Clara, CA 95050
 tel: 408.985.7200
 fax: 408.985.7260
 www.VerdeDesigninc.com

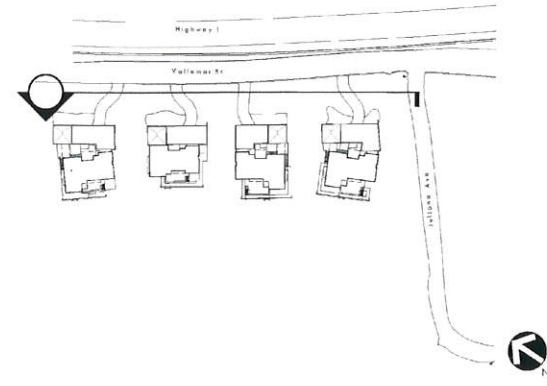

STAMP

CONSULTANT

SHEET TITLE
**VALLEMAR ST.
 ELEVATION/
 PERSPECTIVE**

PROJECT NAME
**MOSS BEACH
 OCEAN
 DEVELOPMENT**

PROJECT ADDRESS
**VALLEMAR ST. &
 JULIANA AVE
 MOSS BEACH, CA**

SUBMITTAL	DATE
DESIGN REVIEW APPLICATION	08/21/15
DESIGN REVIEW RESUBMITTAL	08/09/16

NO.	REVISIONS	DATE
△		
△		
△		
△		
△		
△		

DRAWN BY PH	CHECKED BY MB
DATE ISSUED 08/23/17	SCALE AS SHOWN
PROJ. NO. 1500600-1668	
SHEET NO. L1.1 OF SHEETS	



VALLEMAR ST. PERSPECTIVE

ATTACHMENT C

Project Perspective From Vallemar Ave.



VERDE DESIGN
 LANDSCAPE ARCHITECTURE
 CIVIL ENGINEERING
 SPORT PLANNING & DESIGN
 2455 The Alameda
 Santa Clara, CA 95050
 tel: 408.985.7200
 fax: 408.985.7260
 www.VerdeDesigninc.com

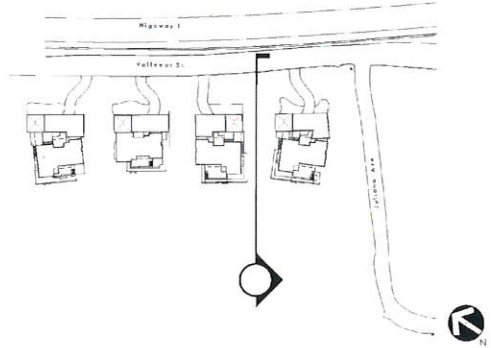

CONSULTANT

SITE SECTION

PROJECT NAME
**MOSS BEACH
 OCEAN
 DEVELOPMENT**

PROJECT ADDRESS
**VALLEMAR ST. &
 JULIANA AVE
 MOSS BEACH, CA**

SUBMITTAL	DATE
DESIGN REVIEW APPLICATION	08/21/15
DESIGN REVIEW RESUBMITTAL	08/09/16

NO.	REVISIONS	DATE
△		
△		
△		
△		
△		

DRAWN BY PH	CHECKED BY MB
DATE ISSUED 08/23/17	SCALE AS SHOWN
PROJ. NO. 1500600-1668	
SHEET NO. L1.2	

SITE SECTION



Project Section (Lot 1) from Site's North Side Looking South

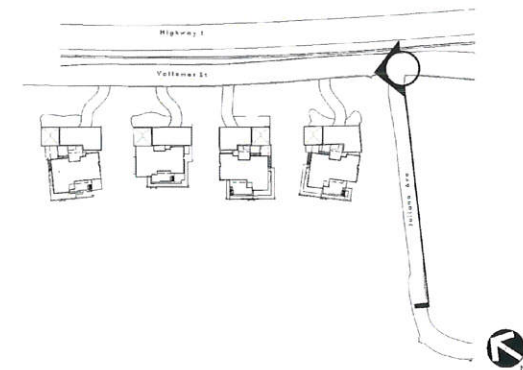

PDC
PEARSON
DESIGN GROUP

VERDE DESIGN
LANDSCAPE ARCHITECTURE
CIVIL ENGINEERING
SPORT PLANNING & DESIGN
2455 The Alameda
Santa Clara, CA 95050
tel: 408.985.7200
fax: 408.985.7260
www.VerdeDesignInc.com

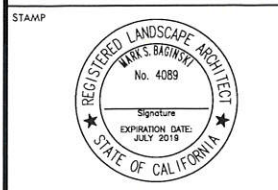

STAMP

CONSULTANT

SHEET TITLE

JULIANA AVE.
SECTION/
PERSPECTIVE

PROJECT NAME

MOSS BEACH
OCEAN
DEVELOPMENT

PROJECT ADDRESS

VALLEMAR ST. &
JULIANA AVE
MOSS BEACH, CA

SUBMITTAL	DATE
DESIGN REVIEW APPLICATION	08/21/15
DESIGN REVIEW RESUBMITTAL	08/09/16

NO.	REVISIONS	DATE
△		
△		
△		
△		
△		

DRAWN BY PH CHECKED BY MB

DATE ISSUED 08/23/17 SCALE AS SHOWN

PROJ. NO. 1500600-1668

SHEET NO. L1.3 OF SHEETS

JULIANA AVE. SECTION/PERSPECTIVE
Project Section (Lot 4) from Julianna Looking North